

## SENSOR OPERATED

## Dualflow Plus



**M14A**  
White finish



**M14AB**  
Black finish



**M14ACS**  
Satin finish

### General description

- The Dualflow Plus is a fast, energy efficient, ecologic, hygienic & stylish hand dryer.
- “Hands in” model, it has 2 pairs of IR sensors on both sides of the upper covers for instant hand detection
- Maximum air speed 410 Km/h.
- Dries hands in only 8 / 15 seconds.
- Motor power adjustable, allowing electricity consumption to be regulated (between 420 and 1.500W).
- Biocote® antimicrobial and antibacterial protection technology based on silver ions. These ions inhibit the reproduction of micro-organisms in the product throughout its lifetime.
- 30 seconds safety timer.
- Lowest noise level in its category. (62 dBA in ECO mode).
- Suitable for medium and high traffic facilities.
- Easy maintenance.

### Components & materials

- **M14A:** ABS cover, white finish.
- **M14AC:** ABS cover, satin finish.
- **M14AB:** ABS cover, black finish.
- **COVER:** made of high impact ABS.
- **BASE PLATE:** made of plastic PA6V0.
- **MOTOR:** high speed class F universal brush motor, adjustable from 19000 to 30000 rpm, allowing electricity consumption and sound pressure to be regulated.
- **HEATING ELEMENT:** minimum waved wire NiCr heating element of 400W, mounted on a mica frame that incorporates a self-resetable thermal cut-off which disconnect the whole appliance. The heating element can be disconnected by means of an ON/OFF switch.
- **HEPA FILTER MEDIA:** cartridge that holds an HEPA filter medium that filters suspended solid particles (pollen, dust mites, cigarette smoke, etc.), notably improving the air quality. Furthermore, this cartridge also contains and activated carbon filtering medium that neutralizes odours and absorbs fumes and gases, helping avoid bad odours.

### Technical Specifications

<b>Voltage</b>	220- 240 V
<b>Frequency</b>	50/60 Hz
<b>Electrical Isolation</b>	Class I
<b>Total power</b>	420 – 1.500 W
<b>Consumption</b>	3.2 – 6.4 A
<b>Motor power</b>	420 – 1,500 W
<b>Rpm</b>	19,000 – 30,000
<b>Heating element power</b>	400 or 0 W (ON/OFF switch)
<b>Dimensions</b>	665x320x228 mm
<b>Weight</b>	8,3 Kg
<b>Cover thickness</b>	3 mm
<b>Drying time</b>	8-15 seg.
<b>Effective airflow</b>	94-165m3/h –1,570-2,750 l/min
<b>Air velocity</b>	234 – 410 Km/h
<b>Air temperature (10 cm distance/21°C)</b>	40 °C
<b>Sound pressure (*) (at 2m)</b>	62 – 72 dBA
<b>Protection rating</b>	IPX4

(\*) According to UNE EN ISO 11201:2010 V2 standard.

### Dimensions

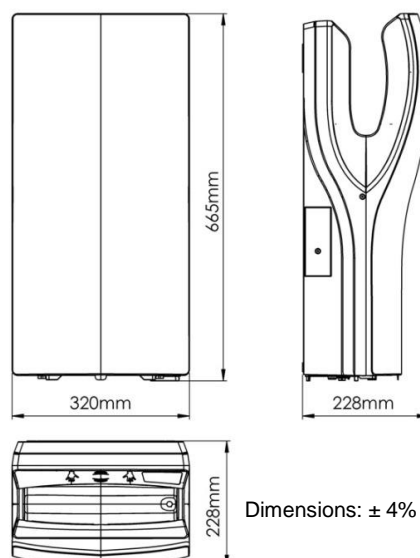

Dimensions: ± 4%

- **IONIZER:** cleans and purifies the air through negative ions (anions) which remove microscopic particles from the air making it healthier (optional).
- **CONNECTION TO THE WASTE PIPE:** optionally, and by means of a kit for the connection to the waste pipe, code KITDESM14A, the Dualflow Plus can be connected directly to the waste pipe. Thus, the emptying of the water tank is eliminated because the water always goes directly to the waste pipe.
- **INNER TANK:** collects the water. It is removable and it has an external valve for easy emptying.
- Optionally, and by means of a kit for the connection to the waste pipe, code KITDESM14A, the Dualflow Plus can be connected directly to the waste pipe.
- **AUTO CHECK-IN LIGHTING PANEL:** for fast diagnosis of the dryer (green - machine running, blue - full tank, red - check engine). Optical and acoustic warning of full tank.
- **ODOR NEUTRALIZER:** for a cleaner and more pleasant atmosphere in the bathroom. (optional).

## Operation

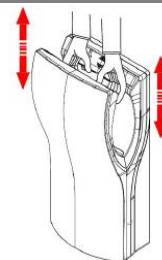

Place the hands between the air outflow valves, inside the hand dryer. The dryer will start automatically, and go on with no interruption as long as the hands are kept in the detection range of the sensor. Move the hands vertically in order to dry them completely. The appliance will stop 2 seconds after the hands are removed from the airflow.

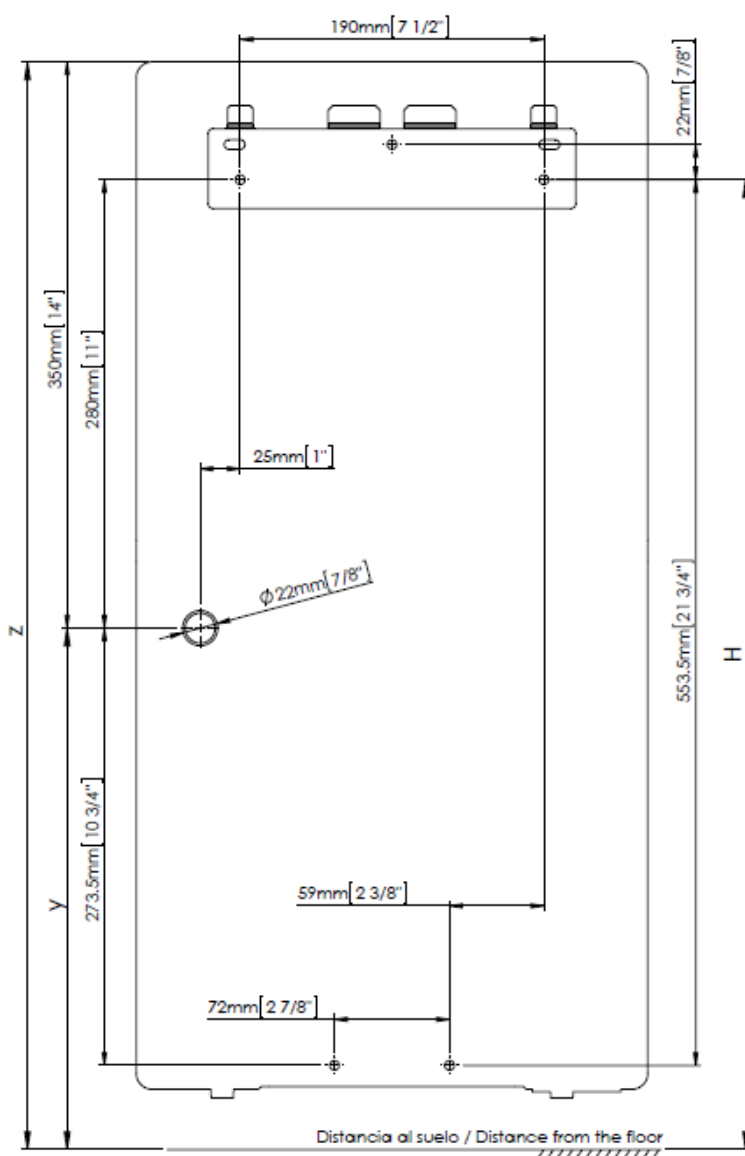

## Mounting

### Recommended heights distance from the floor



			
Z =	92 cm (36 1/4")		87 cm (34 1/4")
H =	85 cm (33 1/2")		80 cm (31 1/2")
Y =	57 cm (22 1/2")		52 cm (20 1/2")

## Connection to the waste pipe

**1**

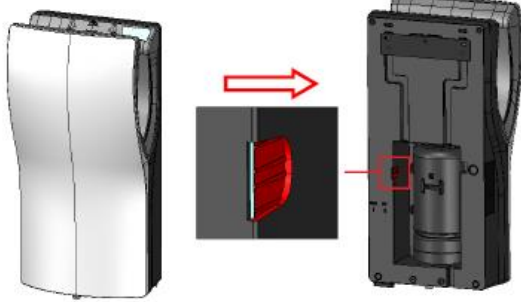

Break the flap on the rear side of the hand dryer base.  
Use a screwdriver and a hammer to do it more easily

**2**

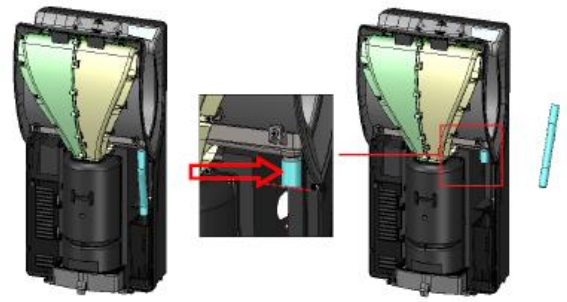

Disassemble the frontal cover and cut the original drain tube skim to the plastic union using a cutter

**3**



Introduce one end of the new tube through the new hole in the backside and fix the other side over the remaining part of the cut old tube using the provided flange

**4**

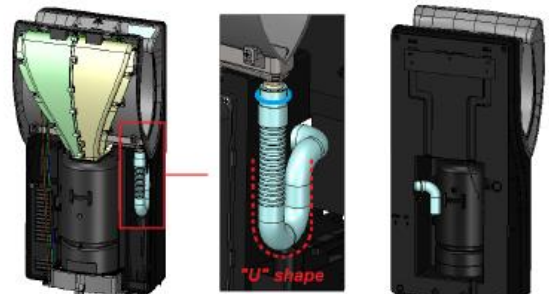

Confirm that the new tube maintains a "U" shape once assembled and connect the backside part of the tube to the waste pipe. Finally, assemble the frontal cover.

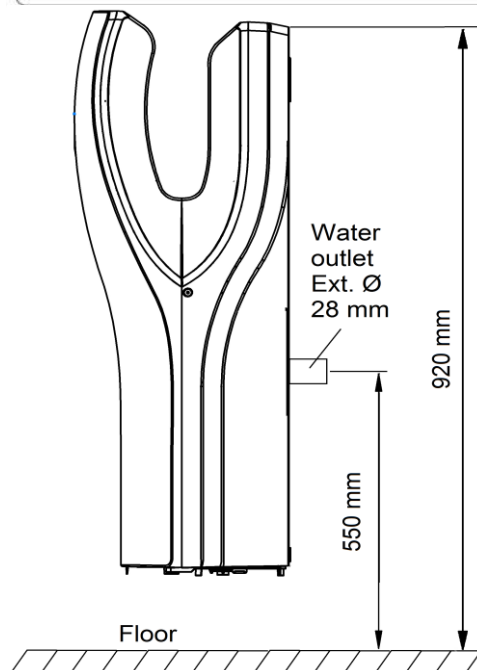

If the hand dryer is installed according to the installation instructions (upper back part of the dryer at 920 mm height), the main drain pipe installation should be approximately 450 mm from the water outlet height to the floor.

For other installation heights, the proportions shown in the figure on the left side must be taken into account.

## Certificates & Qualifications



Mediclinics, S.A., reserves the right to make changes and/or modifications to the products and their specifications without prior notice.  
Review: 05-18 © mediclinics S.A.

